

FUNDATII STALPI ELECTRIFICARE
POWER POLE FOUNDATION
SCARA/ SCALE 1:20

Toate tipurile de oțel (în special Bst 500) vor avea obligatoriu clasa de ductilitate C.
All types of steel (especially Bst 500) will mandatory have the ductility class C.

PLAN FUNDATIE STALP ELECTRIFICARE
POWER POLE FOUNDATION PLAN

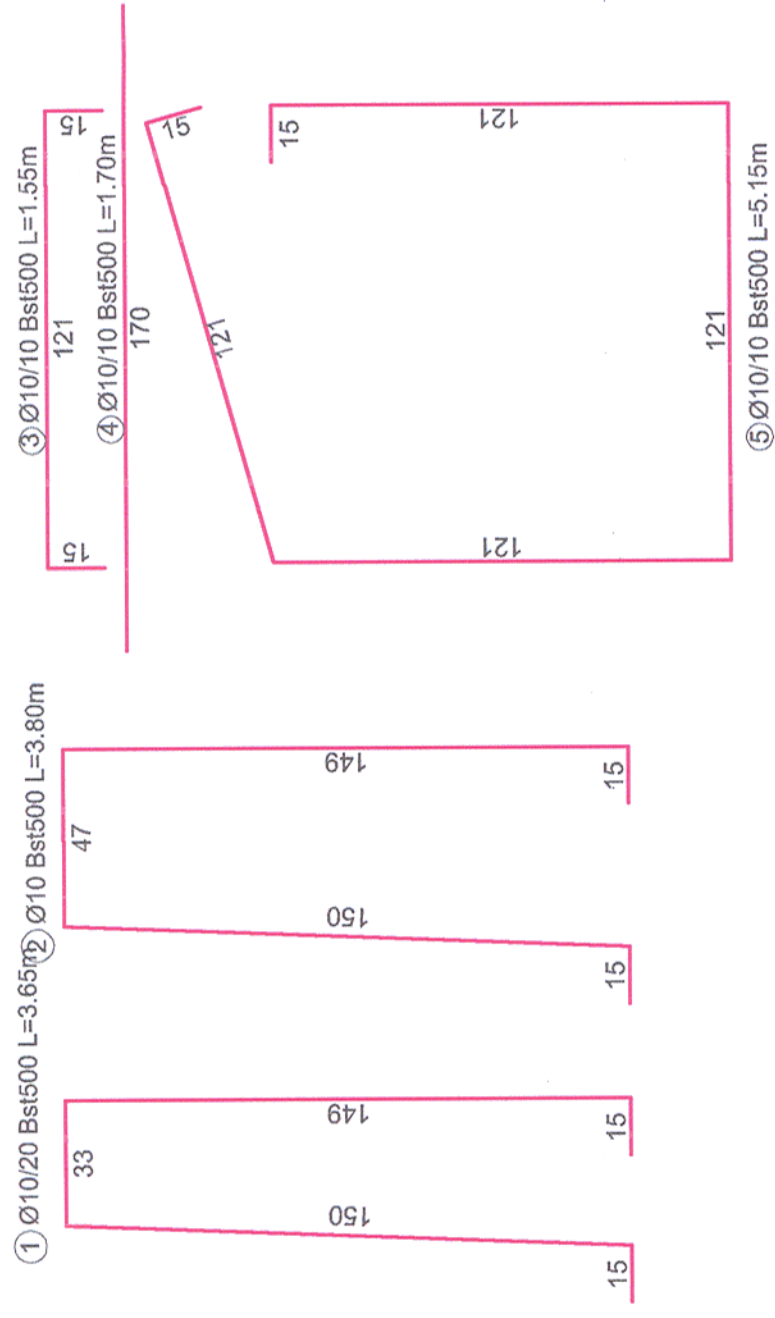
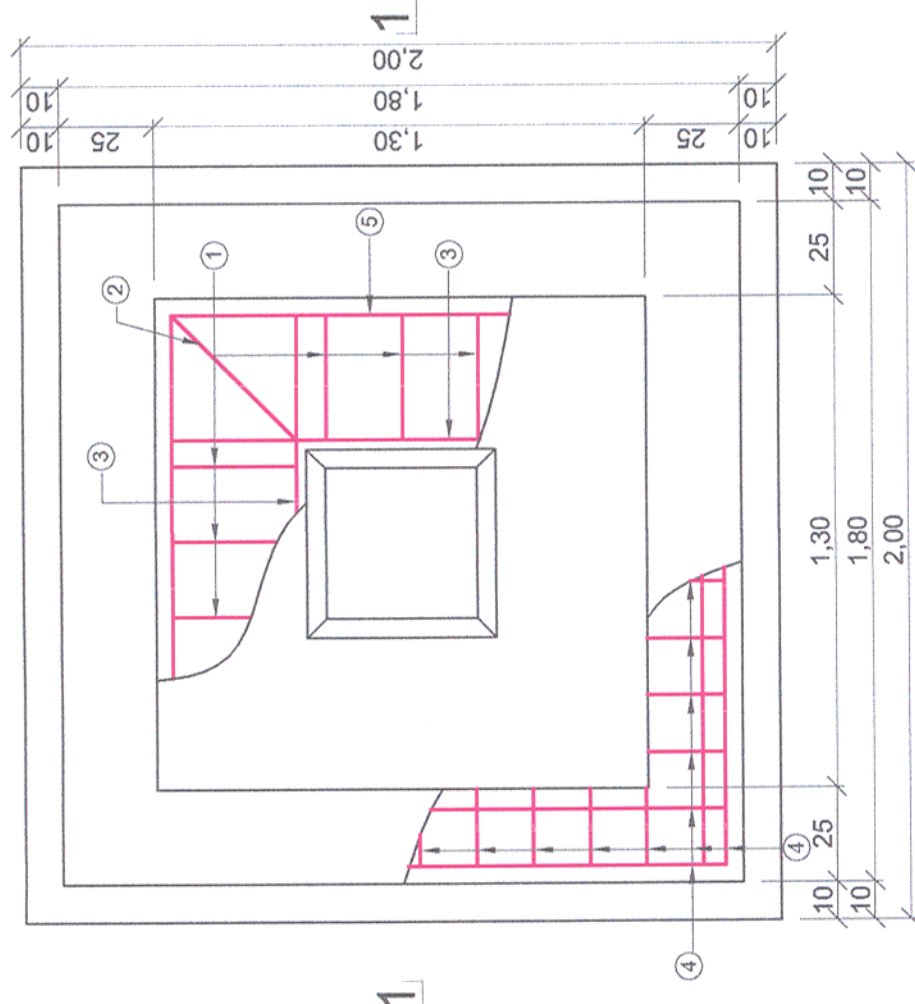

SECTIUNE /SECTION 1-1

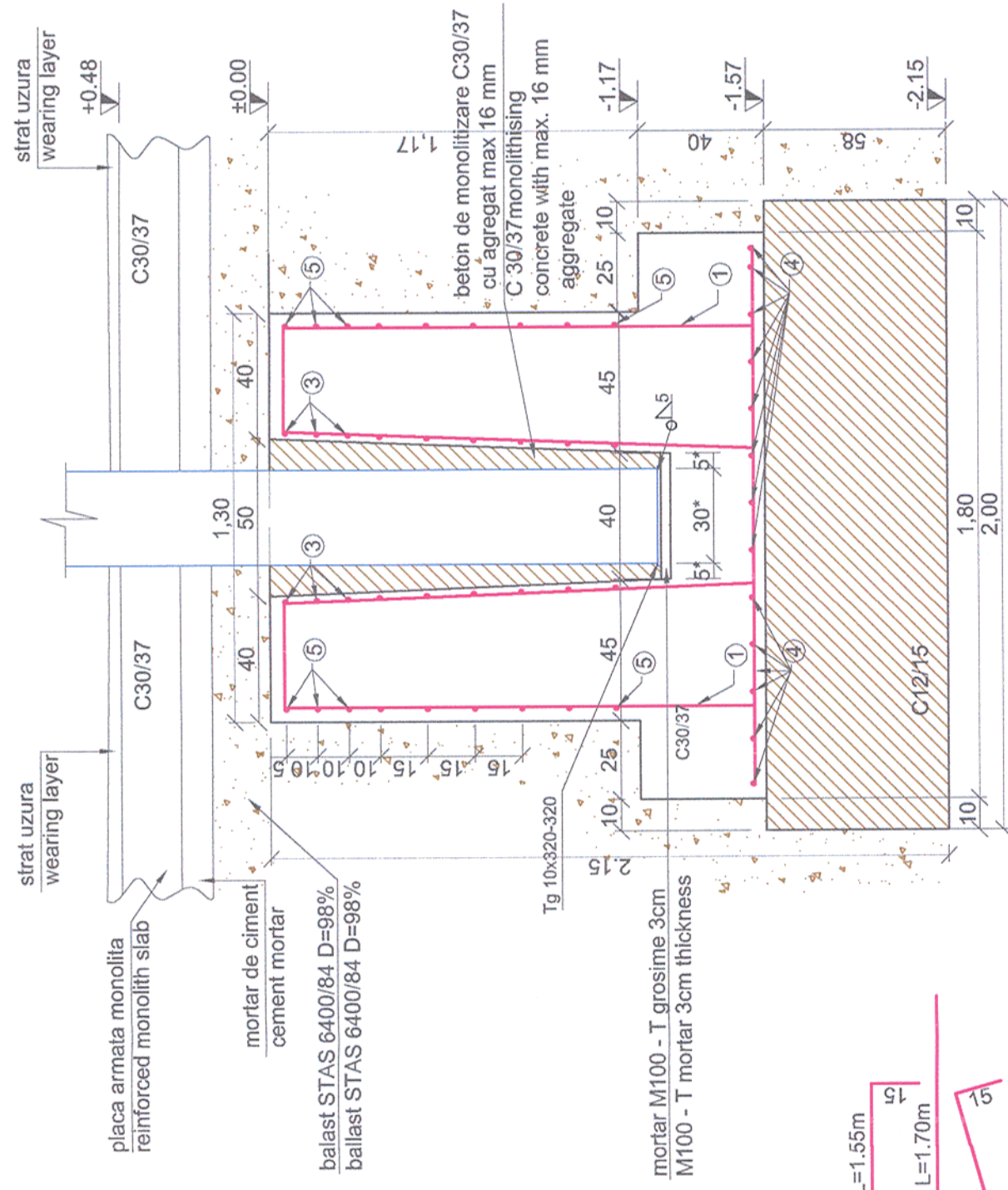

Cotele notate cu * vor fi adaptate pe teren in functie de dimensiunile stalpului
The quotas marked with * will be adapted on fiel, function of the pole's dimensions

Nr.	Diam	Lungime	Buc.	Bst500(S500)
1	10	3.65	12	43.80
2	10	3.80	4	15.20
3	10	1.55	36	55.80
4	10	1.70	26	44.20
5	10	5.15	9	46.35
LUNGIMI/diam				205.4
Greutati Diam/ml				0.616
Greutati Kg/diam				126.5
TOTAL pe tip oțel				126.5
TOTAL GENERAL				126.5

Acest plan anuleaza si inlocuieste planul nr. PT.03.03.22.RE.01.008 elaborat la data 01.2013.

This layout plan canceled and replaced layout plan no. PT.03.03.22.RE.01.008 prepared on 01.2013.

Verificator / Expert Checker / Expert	Cerinta Requirement	Semnatura Signature	Referat / Expertiza Report / Expertise
European Investment Bank	MINISTERUL TRANSPORTURILOR	MINISTERUL TRANSPORTURILOR	
	BENEFICIAR / BENEFICIARY :	COMPANIA NAȚIONALĂ DE CĂI FERATE "CFR" SA	

PROIECTANT / DESIGNER:



Aprobat Approved	Șef de echipă Team leader	C. Teodorescu	Data Date	01.2013	Semnatura Signature	
Verificat Checked	Expert Cheie Key Expert	R. Witan	01.2013			



Subcontractant / Subcontractor	A.M. Baicu	01.2013
Adjunct Șef de echipă Deputy Team leader	S. Petrea	01.2013

"Reabilitarea liniei c.f. Frontiera - Curtici - Simeria, parte componentă a coridorului IV Pan - European pentru circulația trenurilor cu viteză maximă de 160 km/h"
Tronsonul 3: Gurasada - Simeria
"Rehabilitation of the Railway Line Border - Curtici - Simeria, component Part of the IV Pan - European Corridor for the Trains Circulation with maximum speed of 160 km/h"
Section 3: Gurasada - Simeria

Denumire desen / Drawing name:
Fundaji stlpi electrificare Iliia/Illia power pole foundation

Scara / Scale 1:20	Revizia / Revision 1/05.2013	Cod desen / Drawing Code PT.03.03.22.RE.01.008	Nr / No 08/08
-----------------------	---------------------------------	---	------------------